



# OMNI GEAR®

## HDY-20 Pump Drive

Options include:

- SAE A & B flanges
- Metric Group 3 flanges
- 1:2.18 and 1:3.75 ratios
- Adaptor splines to fit common pump shafts
- Male and Female inputs
- Ideal for pump drives, gensets, and water pumps
- Cast iron housing for maximum strength
- Nitrile seals with Viton option
- Choice of standard lubrication or synthetic



### Flange Options

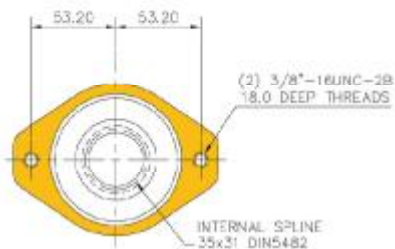

SAE A Flange

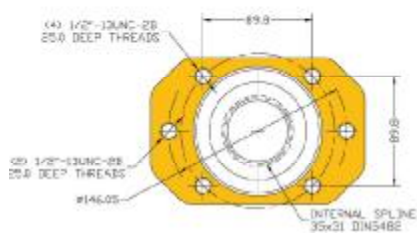

SAE B Flange

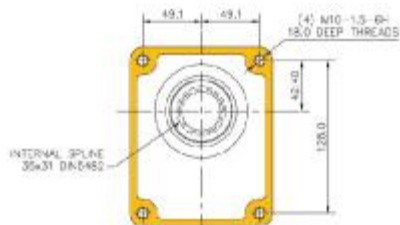

Group 3P Pump Flange

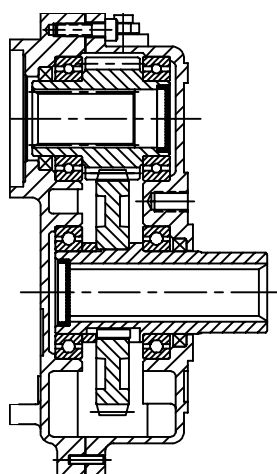

Female Input Shaft

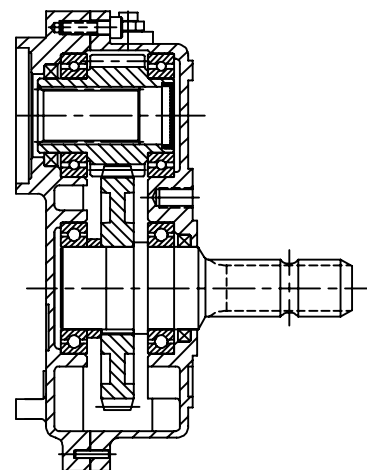

Male Input Shaft

### Spline Adaptor Options

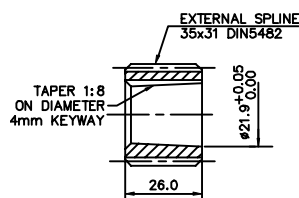

4mm Tapered Keyed Bore

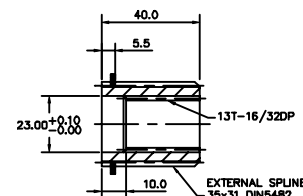

13T-16/32DP Spline Bore





# OMNI GEAR®

## HDY-41 Pump Drive

Options include:

- SAE B & C flanges
- Metric Group 3 flanges
- 1:2 and 1:4 ratios
- Adaptor splines to fit common pump shafts
- Male and Female inputs
- Ideal for pump drives, gensets, and water pumps
- Cast iron housing for maximum strength
- Viton seals
- Synthetic lubrication



### Flange Options

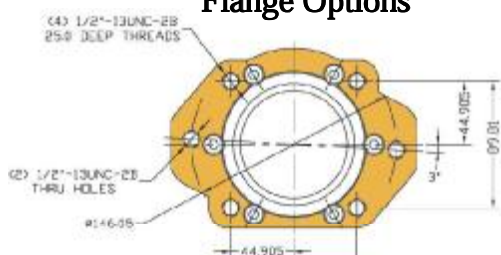

SAE B Flange

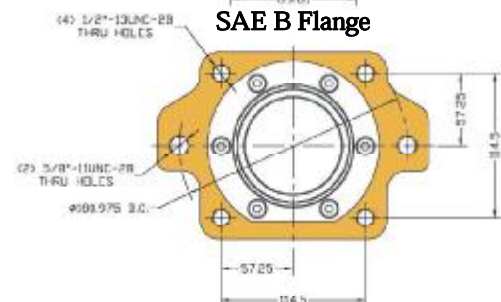

SAE C Flange

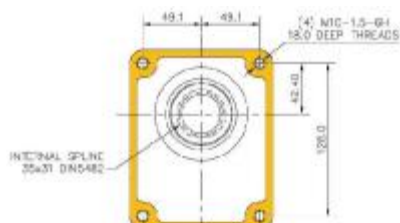

Group 3P Pump Flange

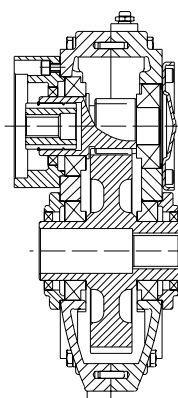

Female Input Shaft

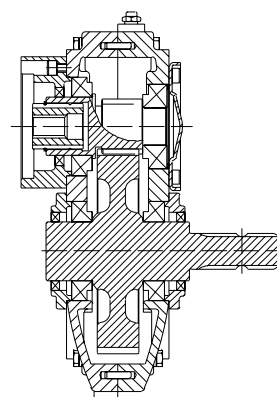

Male Input Shaft

